

## GVA

### Version 1 – Level Probe with stainless steel housing

Electric interface through terminal screws in the probe head. Cable feed out through a M16 gland, for protection class IP 65.

- Electrode length available 5 to 4000mm (please specify with your order)
- 1 - 7 electrodes
- For heavy-duty
- All parts which may touch the medium are made from physiologically harmless materials (with Polyolefin coating)
- For conductive filling level acquisition



#### Technical data

**Mounting method:** Thread  
**Mounting orientation:** any  
**Case temperature:** max. +110°C  
**Media temperature:** max. +120°C  
 (Polyolefin max. 100°C)  
**Media pressure:** max. 10 bar

**Probe-head material:** V2A / 1.4305 Cover and Cable gland brass, nickel-plated  
**Electrode material:** V4A / 1.4571 (optional HAC-C4; Titanium)  
**Coating:** Kynar (optional Polyolefin)  
**Sealing ring:** FPR

Size	Electrodes	Standard-Model
1/2"	1	GVAE - 1VK1
1/2"	1 (2)*	GVAE - 1VK1R
1/2"	2	GVAE - 2VK1
1"	2	GVAG - 2VK1
1"	3	GVAG - 3VK1
1"	4	GVAG - 4VK1

Size	Electrodes	Standard-Model
1 1/2"	2	GVAI - 2VK1
1 1/2"	3	GVAI - 3VK1
1 1/2"	4	GVAI - 4VK1
1 1/2"	5	GVAI - 5VK1
1 1/2"	6	GVAI - 6VK1
1 1/2"	7	GVAI - 7VK1

⚠ To order the Polyolefin-coated version insert „P“ instead of „K“ – e.g. „GVAE - 1VP1“.

\* Single pole probe with the reference connection tied to the mounting for use in electrical conductive vessels, functionality is the very same as for a bipolar probe.

#### Dimensions

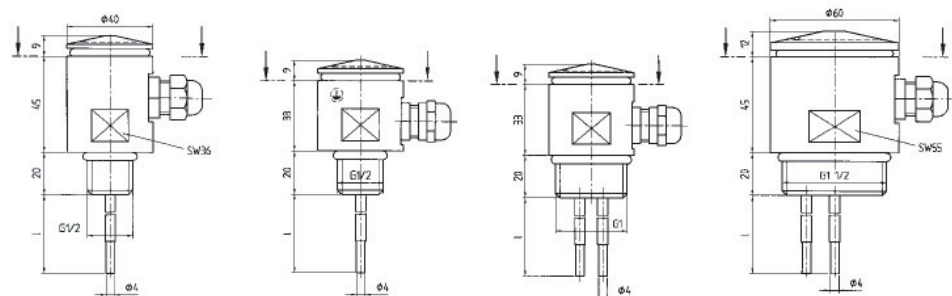

#### Options

**Mounting bracket:** Material V2A / 1.4301  
**Cable gland:** Material V2A / 1.4301  
**Junction cable:** with numeric labeled wires